

## 环辊磨 Roller Mill

### 工作原理

环辊磨采用冲击、挤压、研磨的原理对物料进行粉碎，固定在磨轮支架上的磨轮与销轴之间有很大的活动间隙，当磨轮支架随主轴进行公转时，磨轮受离心力的作用向磨圈，并压紧磨圈内壁又围绕销轴作自转，物料通过磨轮与磨圈的间隙时，受到磨轮的冲击、挤压、研磨而粉碎。因此，粉碎效率高，物料粉碎充分，细度好。经国内知名专家学者认定该机型是目前国内先进的干法非金属矿超细粉体细磨设备。

### 特点

- 投资省、效益高：与大型成套设备相比，投资节省了60%；
- 低能耗：与球磨机及其它产品比较，能耗可降低30%左右；
- 分级精度高：采用内分级装置，分级轮结构独特，分级效果好，无大颗粒污染。
- 磨耗低：粉碎副各易损件采用特殊耐磨合金制造，使用寿命长。
- 400目 (D97=43um) 产量可达6吨/小时；  
1250目 (D97=10um) 产量可达2吨/小时；  
3000目 (D97=5um) 产量可达1.2吨/小时。

## 技术参数： Technical Parameters

机型 Model 目数 Mesh	MT-188		HLM-880D		HLM-580	
	产量 (kg/h) Capacity	电耗 (kw) Power	产量 (kg/h) Capacity	电耗 (kw) Power	产量 (kg/h) Capacity	电耗 (kw) Power
400目	6000-7000	22	4000-5000	27	1000-1200	50
800目	3000-3500	45	1800-2100	60	800-900	70
1250目	2000-2500	70	1200-1500	95	450-550	110
1500目	1800-2000	73	1000-1200	110	350-400	140
1800目	1500-1800	90	800-1000	136	300	185
2500目	1200-1300	120	600-800	175	—	—
3000目	900-1100	145	500-700	200	—	—



### PRINCIPLE

The Roller mill adopt impact, extrusion, grinding and other principles to crush the material, there's big gap between the grinding wheel and the pin bearing. when the grinding wheel support rotate with the main shaft, the grinding wheel will throw to the grinding ring under the centrifugal force, and press the inner wall of the grinding ring tightly and rotate round the pin bearing, when the material through the gap between the grinding wheel and grinding ring, it will grind under the impact, extrusion and grinding. Widely used for dry non-metallic ultra-fine powder.

### FEATURES

Less investment, high efficient: it can save 60% compared to other complete set of equipment;  
Low energy consumption: The energy consumption can reduce 30% compared to ball mill;  
High classification precision: adopt inner classifying device, special classifying wheel structure, no large particle pollution.  
Low abrasion: the pulverize friction with special resistant alloy parts manufacturing, long service life  
The capacity could reach 6t/h for 400 mesh (D97=43um);  
The capacity could reach 2t/h for 1250 mesh (D97=10um);  
The capacity could reach 1.2t/h for 3000 mesh (D97=5um);

## 星型出料阀 Rotary Valve

星型出料阀采用我公司进口数控加工中心制作，一次成型，产品精度高，密闭性能好，广发运用于化工、制药、粮食加工等行业

The rotary valve is processed by our CNC processing center. It is shaped once with high precision quality, good sealing. The rotary valve is widely used in the Chemical, Pharmaceutical, Foodstuff etc. processing industry.

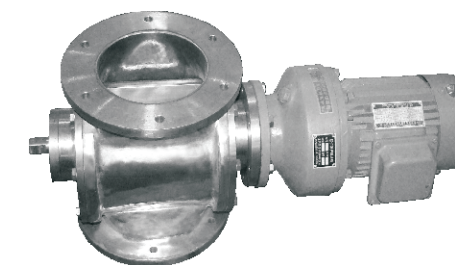

### 星型出料阀主要技术参数 Major Technical Parameters

型号 Model	电机功率 Power	容积 Volume	转速 Rotate Speed	机重 (带电机) Weight
XLF0.5L	0.37KW	0.5L/r	24r/min 或 40r/min	45KG
XLF2L	0.75KW	2L/r	24r/min 或 40r/min	80KG
XLF5L	0.75KW	5L/r	24r/min 或 40r/min	105KG

## 精密过滤器、高效除油器 Precise Filter、Oil remover



### 基本参数

#### Technical Parameters

参数 Parameters	名称 Name	精密过滤器 Precision filter	高效除油器 Oil remover
过滤精度 Filtrate Precision		气体 GAS: 0.01 μm	气体 GAS: 0.01 μm
过滤面积 Filtrate Area		3m <sup>2</sup> , 6m <sup>2</sup> , 10m <sup>2</sup> , 20m <sup>2</sup>	3m <sup>2</sup> , 6m <sup>2</sup> , 10m <sup>2</sup> , 20m <sup>2</sup>